

ZEETORK

— the Automation & Controls Expert —



Z – MOR Series
Quarter Turn Manual Override

Z-MOR Series

Z-MOR SERIES : Quarter Turn Manual Overrides for Pneumatic Actuation

Features:

- 10 models upto 5,000 Nm output torque
- Alloy steel input shafts
- High Performance axial bearings
- Epoxy Primer coating.
- Powder Coated Handwheels for smooth and easy operation
- Stroke-0° to 90° (+/-5°)
- Smooth and easy CLUTCH – DECLUTCH mechanism

PERFORMANCE SPECIFICATIONS OF QUARTER-TURN GEAR OPERATORS (Z- MOR Series)

Options:

- Locking arrangement
- Housing material options (Ductile Iron/Carbon steel/Stainless steel)
- Worm wheel material (Al. Bronze)
- Shaft, Hardware and Handwheel (Stainless Steel)

Specifications:

- Std Enclosure-IP-54 (IP-65-Optional)
- Lubrication – High Performance Grease Filled (NLGI-2)

The Z-MOR series manual overrides are quarter turn devices used to operate pneumatically actuated valves. The Z-MOR series of quarter turn manual overrides are robust industrial grade products manufactured with cast iron housing components.

All models in this series are compact designed, epoxy primer coated and feature high performance axial bearings. The Z-MOR series have optimum ratios for reduced effort during operation.

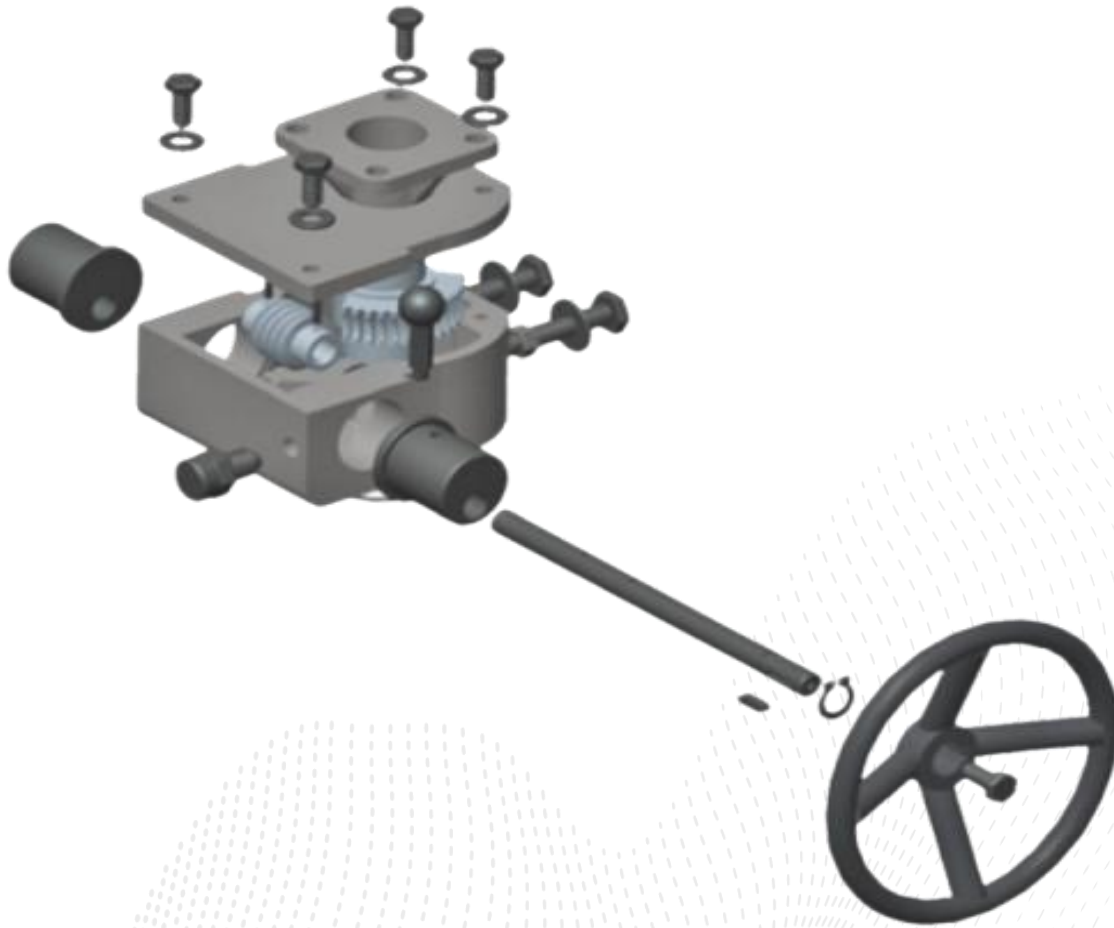

Model	Rated Output Torque (NM)	Mech Advantage +10%	Ratio	Turns to Close	Valve ISO 5211 Mounting	Max Drive Bore	Approx Unit Weight (KG)	Actuator mtg Flange ISO 5211	Handwheel recommended (mm)	ød	A	B	C	D	E	F	G	H	I
Z - MOR 25	250	9	38:1	9.5	F05,F07	25	5	F05,F07	ø175/200	12	83	121	98	126	40	98	28.5	5	48
Z - MOR 65	650	9	38:1	9.5	F07,F10,F12	30	9	F07,F10,F12	ø250/300	14	113	181	146	165	64	146	40.5	4.5	75.5
Z - MOR 150	1500	17	70:1	17.5	F10,F12,F14	50	25	F10,F12,F14	ø400/450	16	150	224	151	230	67	209	44	3	91
Z - MOR 150-2	1500	17	70:1	17.5	F10,F12,F14	50	28	F16	ø400/450	16	150	224	151	230	67	209	44	3	91
Z - MOR 250	2500	17	80:1	20	F12,F14,F16	60	31	F12,F14,F16	ø450/500	20	163	283	215	188	81	276	57.5	9	107
Z - MOR 350	3500	22	90:1	22.5	F16,F25	80	60	F16	ø500/600	20	185	333	270	265	100	342	69	6	126
								F25											
Z - MOR 500	5000	50	264:1	66	F16,F25	80	70	F16	ø600	20	185	379	270	325	100	342	69	10	136
								F25											

ZEETORK

— the Automation & Controls Expert —

Zeetork Automation and Control Pte. Ltd.



Singapore : 22 Sin Ming Lane, #06-06, Midview City, Singapore -573969



**India : S.F.No 617/2H2, Vadakku Thottam, Malumichampatti P.O, L&T road,
Coimbatore - 641021**



www.Zeetork.com



sales@zeetork.com