

## Data Sheet

<p style="text-align: center; font-weight: bold; font-size: 1.2em;">Product Name - Quick Exhaust Valve</p>	
<p style="text-align: center; font-weight: bold; font-size: 1.2em;">Model No - ZQEV</p>	
<p style="text-align: center; font-weight: bold; font-size: 1.2em; text-decoration: underline;">Description of the Product</p> <p>A Quick Exhaust Valve (ZQEV) is a specialized pneumatic device designed to rapidly expel air from a system, significantly increasing the speed of actuator movements such as cylinders and other pneumatic components.</p>	

### Specification and Technical Data

ZQEV - Model	1	2	3	4	5	6
Port size	G1/8"	G1/4"	G3/8"	G1/2"	G3/4"	G1"
Effective Sizing Area	16 mm <sup>2</sup>	27.5 mm <sup>2</sup>	28 mm <sup>2</sup>	71 mm <sup>2</sup>	110 mm <sup>2</sup>	190 mm <sup>2</sup>
Working Medium	Air					
Working Pressure	0~1.0MPa					
Operating Temperature	0~60°C					

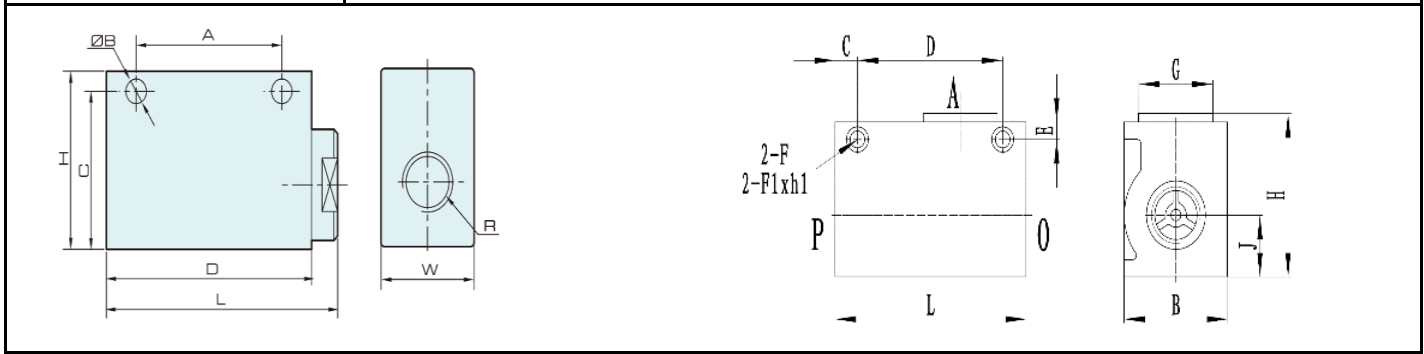

### Drawing & Dimesnions (mm)

Type	Port Size	L	W	H	A	B	C	D
ZQEV-01	G1/8"	46	20	32	30	4.3	27	40
ZQEV-02	G1/4"	62	25	40	39	5.6	33.5	55
ZQEV-03	G3/8"	62	25	40	39	5.6	33.5	55
ZQEV-04	G1/2"	98	38	64	60	8.5	51	90

Type	Port Size	B	C	D	E	F	G	H	J
ZQEV-06	G3/4"	70	15	98	10	10	50	95	36
ZQEV-07	G1"	70	15	98	10	10	50	95	36